

FORM No. 1.

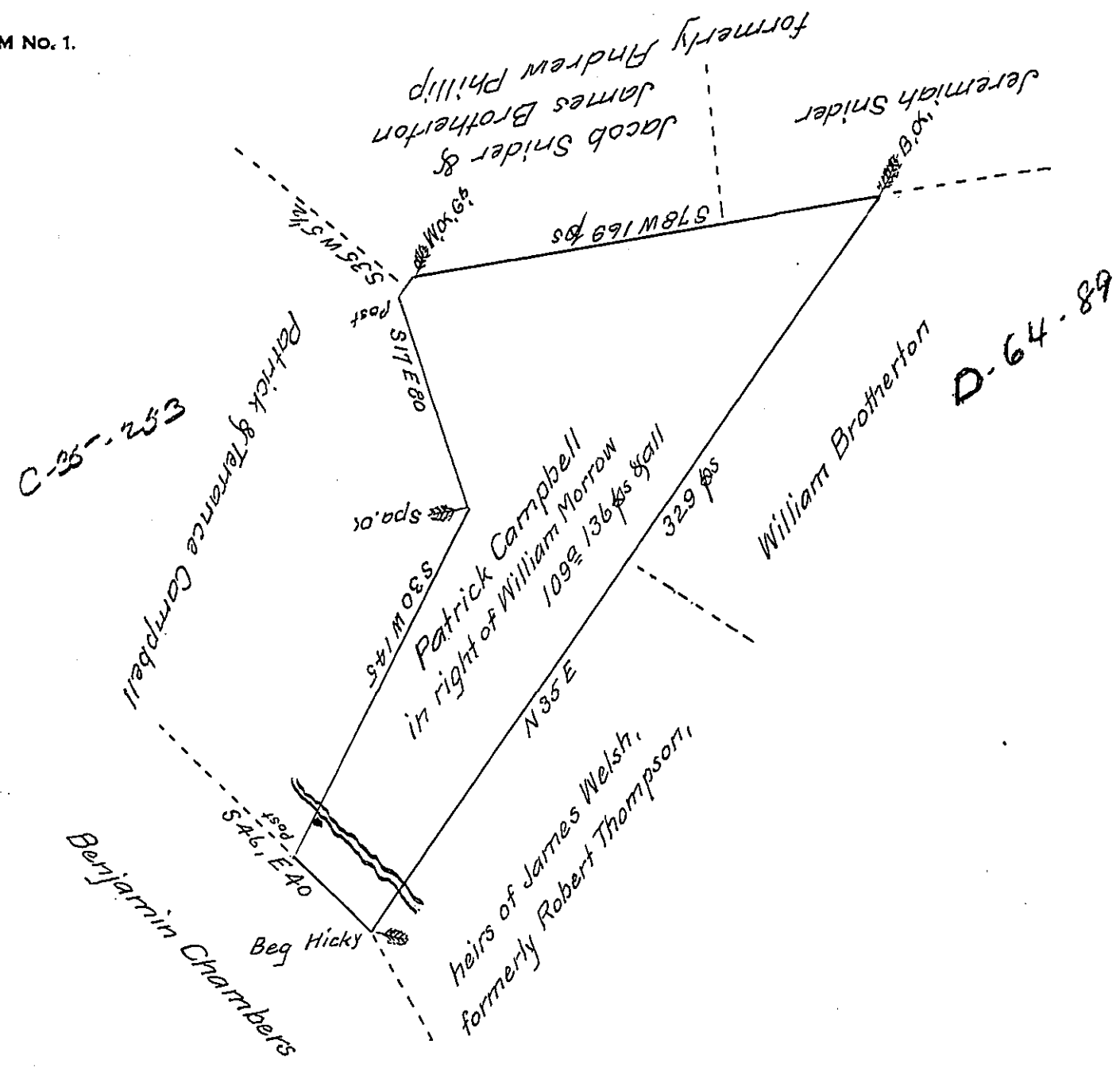

Draught of a Tract of Land situate in in Hamilton Township Franklin County Containing One hundred and nine acres and One hundred and thirty six perches and Allowance of Six ~~per~~ Cent for Roads &c &c Surveyed the 21st day of March 1807 in pursuance of a Warrant Granted, William Morrow ^{for 109 1/2} dated the twenty sixth day of December 1788 ----

Tho, Kirby D.S

The above is examined and Calculated from the notes of Tho Kirby Esq^r late DS filed in the Deputy Surveyors Office of Franklin County Given Under my hand this 29th June 1815- Arch^d Fleming D.S.

Rich^d T. Leech Esq^r
Surveyor General of P. A

IN TESTIMONY that the above is a copy of the original remaining on file in the Department of Internal Affairs of Pennsylvania, made conformably to an Act of Assembly approved the 16th day of February 1833, I have hereunto set my hand and caused the Seal of said Department to be affixed at Harrisburg, this thirteenth day of January 1908.

Henry Houch
Secretary of Internal Affairs.